





Post Color Type

-  5010 Blue (special custom)
-  3020 Red (Original)

PDCH 45 C

2 POST LIFT

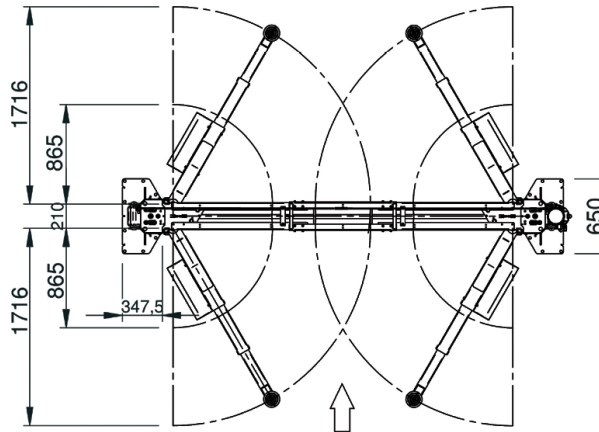
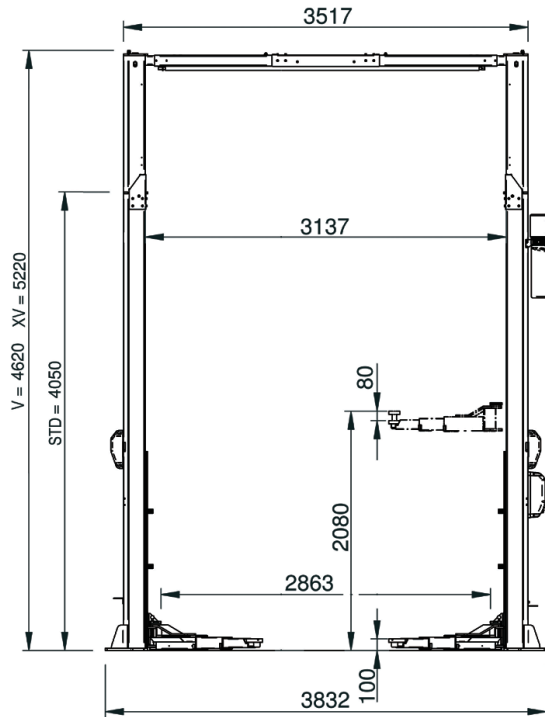

Technical Specification >>>

PDCH 45 C

Lifting Capacity	4500 kg
Lifting Time	45s
Three phase motor	400/230 - 3kW- 3Ph - 50/60Hz
Single phase motor	230V - 3kW - 1Ph - 50/60Hz
Max. lifting height	2080 mm
Lift minimum height	100 mm
Height connection	4050/4620/5220



Electo magnet safety release 24V

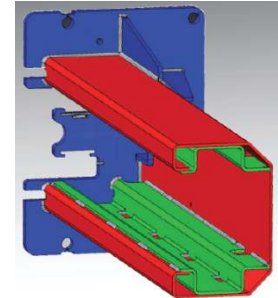

Internally reinforced colomn structure.